

Aina PTT Smart Button

USER GUIDE

AINA Wireless

DOC ID : IU0006 ver. 4.2.

INCLUDED IN THE PACKAGE

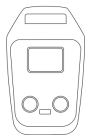

X 1



X 1

BUTTONS AND PARTS

A. Loophole

B. PTT1

C. PTT2

D. LED

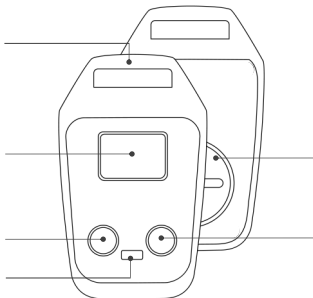

E. Button cell
battery cover

F. Emergency

aina^{PTT}

FLIPPING AND INSERTING BATTERY/ CHANGING THE BATTERY (1)

1

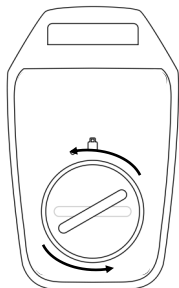

2

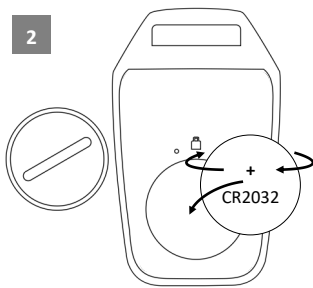

3

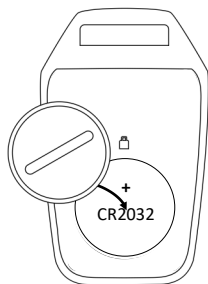

4

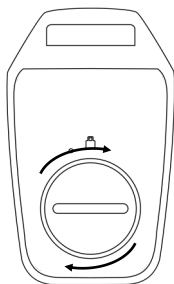

NOTE! The battery type is: CR2032, 3V. This battery needs to fulfill UN Manual of Test and Criteria, Part III, sub-section 38.3. **CAUTION!** Risk of fire or explosion if the battery is replaced with an incorrect battery type.

FLIPPING AND INSERTING BATTERY/ CHANGING THE BATTERY (1)

- EN** 1. Unscrew the button cell battery cover anticlockwise with a tool or coin until it pops up 2. Remove the cover, and remove, flip and re-insert the button cell battery 3. Put the cover back on top 4. Gently push down the cover and screw it clockwise to secure it into place. NOTE! When the button cell battery is inside, the device will be constantly ON. To turn the device OFF, you must remove the battery.
- DE** 1. Lösen Sie die Knopfzellen-Batterie-Abdeckung gegen den Uhrzeigersinn mit einem Werkzeug oder einer Münze, bis sie aufspringt 2. Entnehmen, wenden und setzen Sie die Knopfzellen-Batterie wieder ein 3. Setzen Sie die Abdeckung wieder auf das Gerät 4. Drücken Sie vorsichtig auf die Abdeckung und schrauben Sie sie im Uhrzeigersinn, bis sie fest sitzt. HINWEIS: Wenn die Knopfzellen-Batterie eingelegt ist, bleibt das Gerät konstant EINGeschaltet. Um das Gerät AUSzuschalten, müssen Sie die Batterie entfernen.
- FR** 1. À l'aide d'un outil ou d'une pièce de monnaie, dévissez le couvercle de la pile-bouton dans le sens inverse des aiguilles d'une montre jusqu'à ce qu'il se dégage 2. Retirez, retournez et remplacez la pile bouton 3. Remplacez le couvercle 4. Abaissez doucement le couvercle et revissez-le dans le sens des aiguilles d'une montre afin de le fixer en place. ATTENTION : Lorsque la pile-bouton est à l'intérieur, le dispositif reste constamment ALLUMÉ. Pour ÉTEINDRE le dispositif, vous devez ôter la pile.
- ES** 1. Desenrosca la tapa de la batería hacia la izquierda con una herramienta o moneda hasta que la tapa salga hacia arriba 2. Quita la tapa y quita, gira e re-inserta la batería 3. Vuelve a colocar la tapa encima 4. Presiona la tapa hacia abajo suavemente y enróscala hacia la derecha. ¡NOTA! El dispositivo estará constantemente encendido cuando la batería está adentro. Para apagar el dispositivo se tiene que sacar la batería completamente.

BLUETOOTH PAIRING (1)

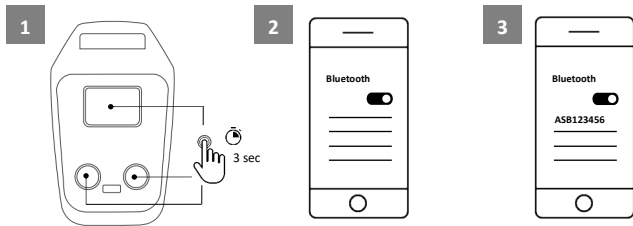

- EN** 1. Press all three buttons simultaneously for 3 seconds to put the device into pairing mode (and remove any previous pairings) 2. Open the phone's Bluetooth settings and turn this function on 3. Select your device from the list. NOTE! Your PTT Smart Button will move from 'Available devices' to 'Paired devices', but it will not appear as connected.

- DE** 1. Halten Sie gleichzeitig alle drei Tasten 3 Sekunden lang gedrückt, um das Gerät in den Kopplungsmodus zu setzen (und ggf. vorherige Kopplungen zu entfernen) 2. Öffnen Sie die Bluetooth-Einstellungen des Telefons und aktivieren Sie diese Funktion 3. Wählen Sie Ihr Gerät aus der Liste aus. HINWEIS! Ihre PTT Smart Button wechselt von "Verfügbare Geräte" zu "Gekoppelte Geräte", wird aber nicht als "verbunden" angezeigt.

BLUETOOTH PAIRING (2)

- FR** 1. Appuyez simultanément sur tous les trois boutons pendant 3 secondes afin de mettre le dispositif en mode couplage (et de supprimer tous les couplages précédents) 2. Ouvrez les paramètres Bluetooth du téléphone et activez cette fonction 3. Sélectionnez votre appareil dans la liste. **ATTENTION!** Votre Aina PTT Smart Button passera de 'Appareils disponibles' à 'Périphériques appairés', mais il n'apparaîtra pas connecté.
- ES** 1. Presiona los tres botones simultáneamente por 3 segundos para activar el modo de conexión (y para eliminar previas asociaciones) del dispositivo 2. Abre la configuración de Bluetooth de tu teléfono Smart y enciende esta función 3. Selecciona tu dispositivo de la lista. ¡NOTA! Tu PTT Smart Button cambiará de "Dispositivos disponibles" a "Dispositivos vinculados/emparejados", pero no aparecerá como conectado.

1. Operating temperature: -20°C - +60°C
2. Operating frequency range: 2400 - 2483.5MHz
3. Bluetooth power level: Class 2 (Smart 2.5mW)
4. Maximum operating altitude: 4000 meters

OPERATION

For more detailed instructions on setting up and using your Aina PTT Smart Button, please visit www.ainaptt.com

CUSTOMER CARE

If any part of the equipment is damaged on arrival, contact the shipper to conduct an inspection and prepare a damage report. Save the shipping container and all packing materials until the inspection and the damage report are completed.

In addition, contact the Customer Care to make arrangements for replacement equipment. Do not return any part of the shipment until you receive detailed instructions from an AINA Wireless representative.

Contact Customer Care at: + 358 40 322 6717 or support@ainaptt.com

1. Betriebstemperatur: -20 °C – +60 °C
2. Betriebsfrequenzbereich: 2400–2483,5 MHz
3. Bluetooth-Leistung: Klasse 2 (Smart 2,5 mW)
4. Max. 4000m

OPERATION

Detailliertere Anweisungen zur Einrichtung und Verwendung Ihres Aina PTT Smart Buttons finden Sie in der Online-Gebrauchsanweisung unter **www.ainaptt.com**

KUNDENDIENST

Sollte ein Teil des Geräts bei Erhalt beschädigt sein, wenden Sie sich an das Versandunternehmen, um eine Untersuchung und die Erstellung eines Schadensberichts zu veranlassen. Bewahren Sie den Versandbehälter und alle Verpackungen auf, bis die Untersuchung und der Schadensbericht abgeschlossen sind.

Setzen Sie sich darüber hinaus mit dem Kundenservice in Verbindung, um die Bereitstellung eines Ersatzgeräts zu vereinbaren. Senden Sie keinen Teil der Sendung zurück, bevor Sie detaillierte Anweisungen vonseiten eines Vertreters von AINA Wireless erhalten haben.

Kontakt Kundenservice: + 358 40 322 6717 / support@ainaptt.com

1. Température de fonctionnement : -20 °C – +60 °C
2. Gamme de fréquences de fonctionnement : 2400–2483,5 MHz
3. Puissance Bluetooth : Classe 2 (Smart 2,5 mW)
4. Max. 4000m

OPÉRATION

Pour obtenir des informations plus détaillées sur la configuration et l'utilisation de votre Aina PTT Smart Button, veuillez consulter le manuel d'utilisation, disponible en ligne sur www.ainaptt.com

SERVICE Á LA CLIENTÉLE

Si une pièce de l'appareil est endommagée au moment de la réception, veuillez contacter l'expéditeur afin qu'il effectue une inspection et prépare un rapport des dommages. Gardez le carton et tous les matériaux d'emballage jusqu'à ce que l'inspection et le rapport soient achevés.

Veuillez également contacter le service client afin d'organiser le remplacement du dispositif. Ne retournez aucune partie du colis avant d'avoir reçu les instructions détaillées d'un représentant d'AINA Wireless.

Contactez le service client : + 358 40 322 6717 / support@ainaptt.com

1. Temperatura de operación: - 20°C - + 60°C.
2. Frecuencia de funcionamiento: 2400 – 2483,5 MHz
3. Nivel de potencia de Bluetooth: Clase 2 (Smart 2,5mW)
4. Altitud máxima de operación: 4000m

OPERACIÓN

Para obtener instrucciones más detalladas sobre cómo configurar y utilizar su Aina PTT Smart Button, por favor consulte el manual del usuario en nuestra página web: **www.ainaptt.com**

ATENCIÓN AL CLIENTE

Si alguna parte del dispositivo está dañada al llegar, póngase en contacto con el remitente para poder realizar una inspección y preparar un informe de daños. Guarde el contenedor de transporte y todos los materiales de embalaje hasta que se complete la inspección y el informe.

También, póngase en contacto con nuestro servicio de atención al cliente para hacer los arreglos necesarios para mandarle un equipo de reemplazo. Por favor, no devuelva ninguna parte del envío hasta que haya recibido instrucciones de uno de los representantes de AINA Wireless.

Servicio de atención al cliente: + 358 40 322 6717 / support@ainaptt.com

USER LEGAL GUIDELINES

AINA Wireless Inc. (AINA Wireless Finland Oy) is continuously evaluating technical publications that have been produced for completeness and technical accuracy. You can assist us in this process by submitting your comments and suggestions to the following address:

AINA Wireless Finland Oy
Joensuunkatu 7G
24100 Salo
Finland

Or email us to support@ainaptt.com

ACKNOWLEDGEMENTS

The software contained in this device is copyrighted by AINA Wireless. Unpublished rights are reserved under the copyright laws of the United States.

SAFETY CONVENTIONS

The following conventions are used throughout this manual to alert the user to general safety precautions that must be observed during all phases of operation, service, and repair of this product. Failure to comply with these precautions or with specific warning elsewhere in this manual violates safety standards of design, manufacture, and intended use of the product. AINA Wireless assumes no liability for the customer's failure to comply with these standards.

EQUIPMENT TYPE

The AINA PTT Smart Button (ASB1) is categorized as professional equipment.

This equipment is not suitable for use in locations where children are likely to be present.

DECLARATION OF CONFORMITY

The material contained herein is subject to U.S. export approval. No export or re-export is permitted without written approval from the U.S. Government. Rated: EAR99 in accordance with U.S. Dept. of Commerce regulations 15CFR774, Export Administration Regulations.

Repairs to this equipment should be made only by an authorized service technician or facility designated by the supplier. The opening of the device's back cover or any repairs, alterations or substitution of parts made to this equipment not approved by the manufacturer will void the user's authority to operate the equipment in addition to the manufacturer's warranty.

This product conforms to the European Union WEEE Directive 2012/19/EU. Do not dispose of this product in a public landfill or open fire. Take it to a recycling center at the end of its life.

Hereby, AINA Wireless Finland Oy declares that the radio equipment type AINA PTT Smart Button (ASB1) is in compliance with Directive 2014/53/EU

The full text of the EU declaration of conformity is available from the following internet address: www.ainaptt.com/certifications

FCC Part 15

15.21

Warning: Changes or modifications to this equipment not expressly approved by the party responsible for compliance could void the user's authority to operate the equipment.

15.105(b)

Note: This equipment has been tested and found to comply with the limits for a Class B digital device, pursuant to part 15 of the FCC rules. These limits are designed to provide reasonable protection against harmful interference in a residential installation. This equipment generates, uses and can radiate radio frequency energy and, if not installed and used in accordance with the instructions, may cause harmful interference to radio communications. However, there is no guarantee that interference will not occur in a particular installation. If this equipment does cause harmful interference to radio or television reception, which can be determined by turning the equipment off and on, the user is encouraged to try to correct the interference by one or more of the following measures:

- Reorient or relocate the receiving antenna.
- Increase the separation between the equipment and receiver.
- Connect the equipment into an outlet on a circuit different from that to which the receiver is connected.
- Consult the dealer or an experienced radio/TV technician for help.

This device complies with part 15 of the FCC Rules. Operation is subject to following two conditions:

1. This device may not cause harmful interference, and
2. this device must accept any interference received, including interference that may cause undesired operation.

FCC RF Radiation Exposure Statement:

This equipment complies with FCC radiation exposure limits set forth for an uncontrolled environment. End users must follow the specific operating instructions for satisfying RF exposure compliance. This transmitter must not be co-located or operating in conjunction with any other antenna or transmitter.

Industry Canada

1. This device complies with Industry Canada license-exempt RSS standard(s). Operation is subject to the following two conditions: (1) this device may not cause interference, and (2) this device must accept any interference, including interference that may cause undesired operation of the device.
2. Le présent appareil est conforme aux CNR d'Industrie Canada applicables aux appareils radio exempts de licence. L'exploitation est autorisée aux deux conditions suivantes : (1) l'appareil ne doit pas produire de brouillage, et (2) l'utilisateur de l'appareil doit accepter tout brouillage radioélectrique subi, même si le brouillage est susceptible d'en compromettre le fonctionnement.

CREDITS

AINA™ is a registered trademark and is of AINA Wireless Inc.

Bluetooth® is a registered trademark of Bluetooth SIG, Inc.

Apple®, iTunes®, iPhone®, and iPad® are registered trademarks of Apple Inc.

iOS™ is a trademark or registered trademark of Cisco in the U.S. and other countries and is used under license.

Google® is a registered trademark of Google Inc. Android™, Google Maps™, Google Earth™, Google Play™, and Gmail™ are trademarks of Google Inc.

All brand and product names are trademarks, registered trademarks, or service marks of their respective holders.

This manual is published by AINA Wireless Inc. without any warranty. Improvements and changes to this manual necessitated by typographical errors, inaccuracies of current information, or improvements to programs and/or equipment, may be made by AINA Wireless Inc. at any time and without notice. Such changes will be incorporated into new editions of this manual. No part of this manual may be reproduced or transmitted in any form or by any means, electronic or mechanical, including photocopying and recording, for any purpose, without the express written permission of AINA Wireless Inc.

Copyright © 2021, AINA Wireless Inc.